

INSTALLATION
PLAQUE ADAPTEUR

1. Enlevez les quatre (4) boulons d'origine qui retiennent la plaque protectrice au châssis du VTT.
2. Fixez la plaque adapteur (FIGURE A, # 1) au châssis du VTT avec quatre (4) boulons hex. M8 x 30mm LG (FIGURE A, # 2), quatre (4) rondelles plates 1/4" DIA. (FIGURE A, # 3) et de quatre (4) douilles d'espacement 3/4" D.E. x 3/8" D.I. x 3/8" LG (FIGURE A, # 4).

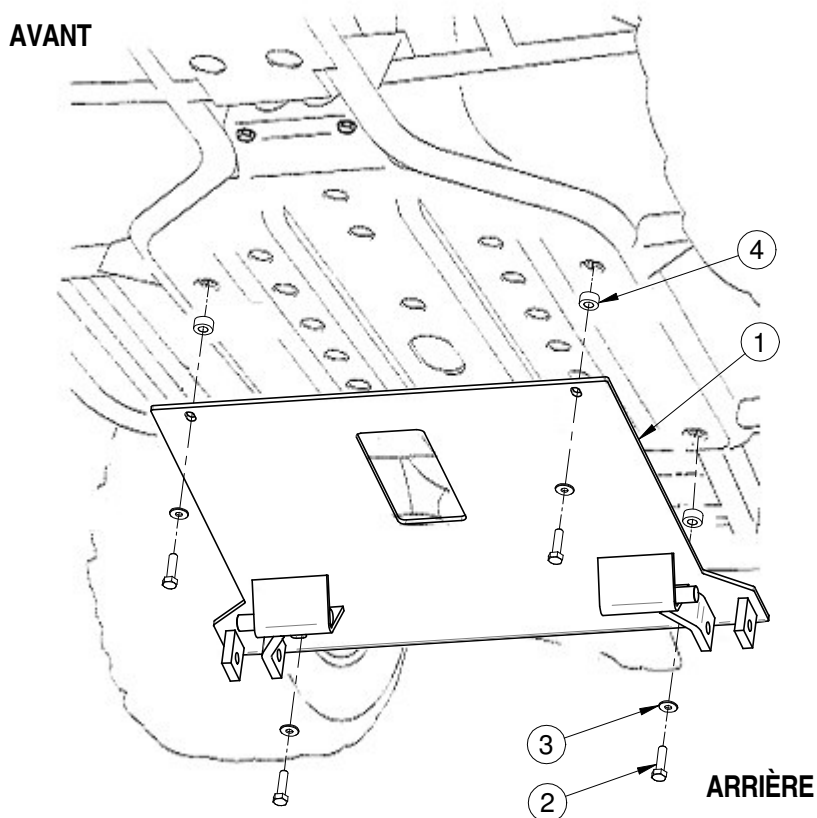

FIGURE A

Liste de pièces

Réf.	Description	# de pièce (OEM)	Qté.
1	Plaque adapteur	00PS-070	1
2	Boulon hex. M8 x 30mm LG	HB-M8x1.25x30	4
3	Rondelle plate 1/4"DIA (W ¼ USS Zinc B)	FW-1/4-USS	4
4	Douille d'espacement 3/4" D.E. x 3/8" D.I. x 3/8" LG (#2)	04DO-002	4



ADAPTER
INSTALLATION

1. Remove the four (4) original bolts retaining the protective plate to frame.
2. Fasten the adapter (FIGURE A, # 1) onto the frame using four (4) hex. bolts M8 x 30mm (FIGURE A, # 2), four (4) flat washers 1/4" DIA. (FIGURE A, # 3) and four (4) sleeves 3/4" O.D. x 3/8" I.D. x 3/8" LG (FIGURE A, # 4).

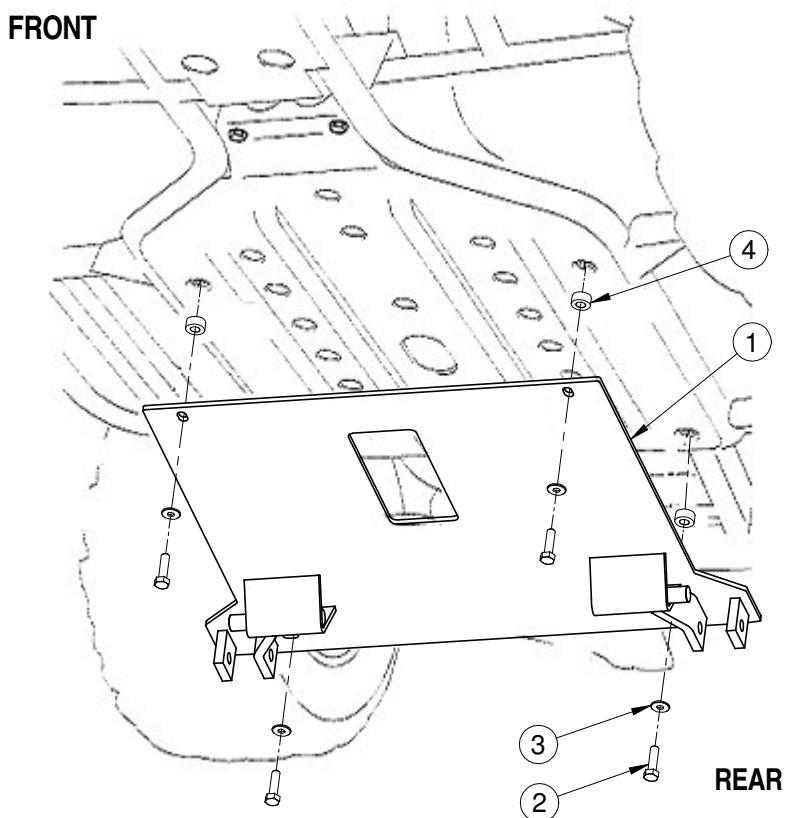

FIGURE A

Parts list

Ref.	Description	Item # (OEM)	Qty.
1	Adapter	00PS-070	1
2	Hex. bolt M8 x 30mm LG	HB-M8x1.25x30	4
3	Flat washer 1/4" DIA. (W ¼ USS Zinc B)	FW-1/4-USS	4
4	Sleeve 3/4" O.D. x 3/8" I.D. x 3/8" LG (#2)	04DO-002	4